



1. Compaction of soils must be prevented. All traffic is to be kept off grass, soils, and other agricultural areas. If compaction occurs, then this must be remediated through subsoil ripping/decompaction techniques - subject to agreement from land owner/farmer/tenant farmer.

2. Crop damage must be kept to a minimum with works ideally taking place when field has been cropped and prior to replanting / seeding works. Arable land to be reinstated upon completion and left bare(unseeded), if approved by land owner/farmer/tenant farmer, or sown with suitable seed mixture.

3. If reinstated areas are within regularly mowed road verges (visibility splay) then a general purpose DfT DoT verge grass seed mix should be used. If areas to be seeded are not within visibility splays, then a Special General-Purpose Meadow Mixture EM3, or suitable equivalent, should be used. Reseeded areas are to be kept free of all traffic and fenced off if required.

4. Existing vegetation should be retained where possible, and any vegetation removed as part of the works should be reinstated if feasible. Any reinstated trees and shrubs are to use biodegradable shelters (e.g. NexGen) with biodegradable ties. Removed vegetation is to be chipped on site, with larger wood/branches cut and placed beneath existing adjacent vegetation for ecological benefits (i.e log piles, hibernacula etc.).

5. If soils are removed during works, then subsoils and topsoils should be kept separate. When soils are reinstated the reclaimed subsoils to be restored first and lightly consolidated, before reclaimed topsoils (circa. top 400mm) are added, consolidated, and scarified ready for seeding.

6. Ditches are to be reinstated upon completion of works and ensured free of obstructions. Bare earth is to be seeded in accordance with note 3. Existing fences are to be retained and reinstated if damaged.

7. Where open-cut trenching is to be undertaken, areas of hard standing to be reinstated to match surrounding hard surface.



Key:

- Site Access
- Existing 'Pole' (to be retained)
- Existing 'Pole' to be replaced with new pole in same location
- New 'Pole' (to be constructed)
- Proposed Order Limits
- Existing 11 kV OHL to be replaced with new section of underground electrical cabling installed by open cutting and filling
- Existing 11 kV OHL to be retained
- Existing 11 kV OHL to be replaced with new section of OHL
- Existing telecoms OHL to be retained
- Proposed telecoms OHL
- Existing telecoms OHL to be removed
- Proposed access

Baseline Phase 1 Habitats

- Standing Water
- Intact hedge - native species-rich
- Fence
- Broadleaved woodland - plantation
- Scrub - dense/continuous
- Improved grassland
- Hard standing
- Cultivated/disturbed land - arable
- Bare ground

Mapping reproduced by permission of Ordnance Survey on behalf of HMSO. Contains OS data © Crown Copyright and database right 2022



PROJECT TITLE			
DRAX BECCS DCO			
DRAWING TITLE			
8.5.2.4 - FIGURE 4 – OHL LANDSCAPE AND BIODIVERSITY PLAN – SHEET 1 OF 2			
DRAWING STATUS			
FOR ISSUE			
DRAWN	CHECKED	APPROVED	AUTHORISED
BS	PP	LR	DK
SCALE @ A3 SIZE		DATE	REVISION
1:1,500		19/04/2023	P03
DRAWING NUMBER			
EN010120-PC-8.5.2.4-Sheet 1			

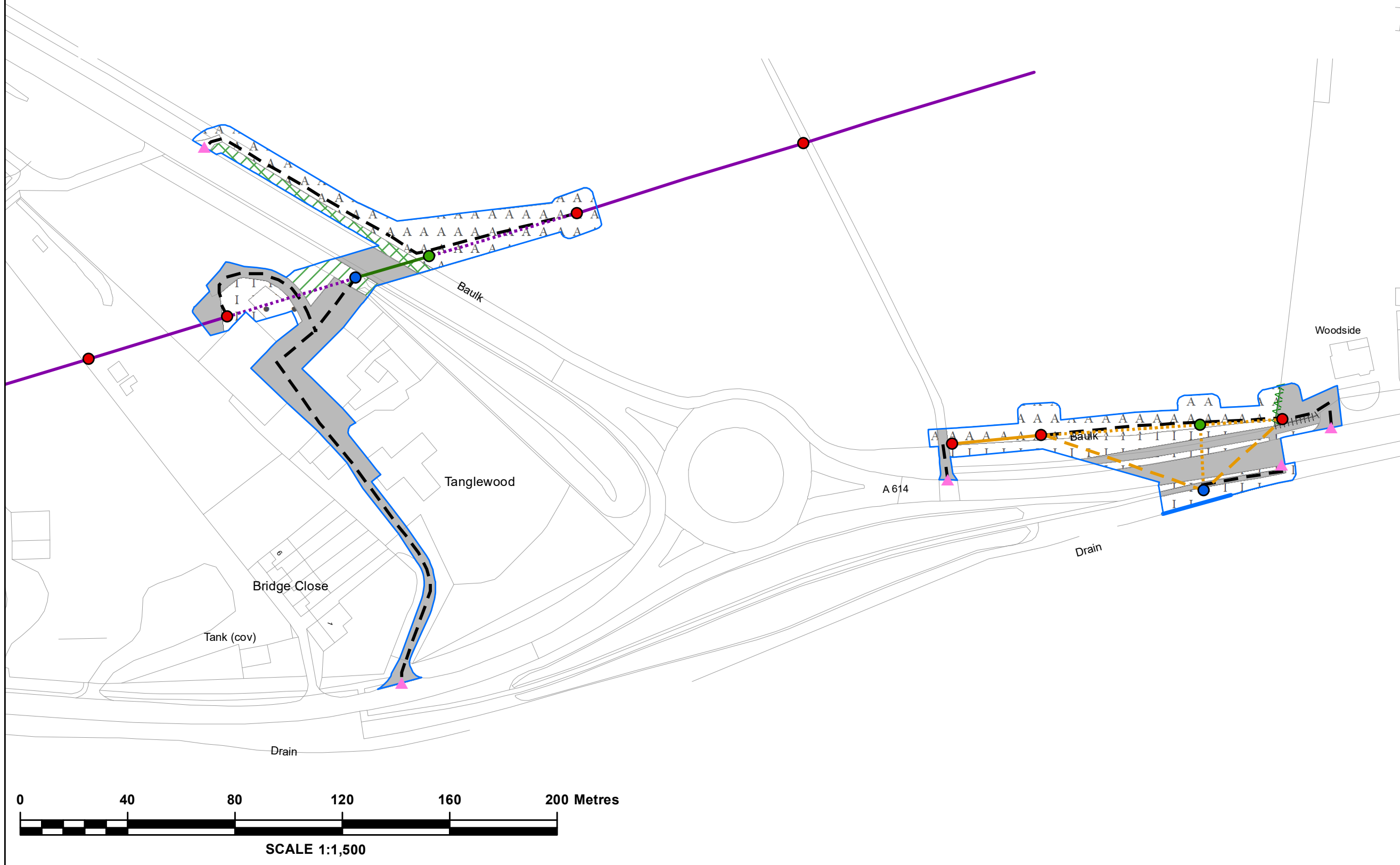



1. Compaction of soils must be prevented. All traffic is to be kept off grass, soils, and other agricultural areas. If compaction occurs, then this must be remediated through subsoil ripping/decompaction techniques - subject to agreement from land owner/farmer/tenant farmer.
2. Crop damage must be kept to a minimum with works ideally taking place when field has been cropped and prior to replanting / seeding works. Arable land to be reinstated upon completion and left bare(unseeded), if approved by land owner/farmer/tenant farmer, or sown with suitable seed mixture.
3. If reinstated areas are within regularly mowed road verges (visibility splay) then a general purpose DfT DoT verge grass seed mix should be used. If areas to be seeded are not within visibility splays, then a Special General-Purpose Meadow Mixture EM3, or suitable equivalent, should be used. Reseeded areas are to be kept free of all traffic and fenced off if required.
4. Existing vegetation should be retained where possible, and any vegetation removed as part of the works should be reinstated if feasible. Any reinstated trees and shrubs are to use biodegradable shelters (e.g. NexGen) with biodegradable ties. Removed vegetation is to be chipped on site, with larger wood/branches cut and placed beneath existing adjacent vegetation for ecological benefits (i.e log piles, hibernacula etc.).
5. If soils are removed during works, then subsoils and topsoils should be kept separate. When soils are reinstated the reclaimed subsoils to be restored first and lightly consolidated, before reclaimed topsoils (circa. top 400mm) are added, consolidated, and scarified ready for seeding.
6. Ditches are to be reinstated upon completion of works and ensured free of obstructions. Bare earth is to be seeded in accordance with note 3. Existing fences are to be retained and reinstated if damaged.
7. Where open-cut trenching is to be undertaken, areas of hard standing to be reinstated to match surrounding hard surface.

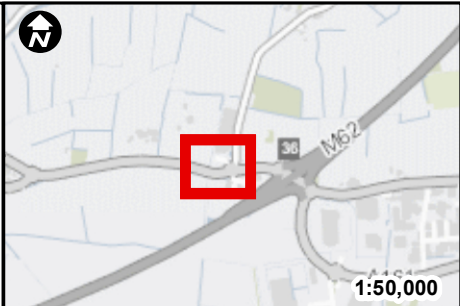
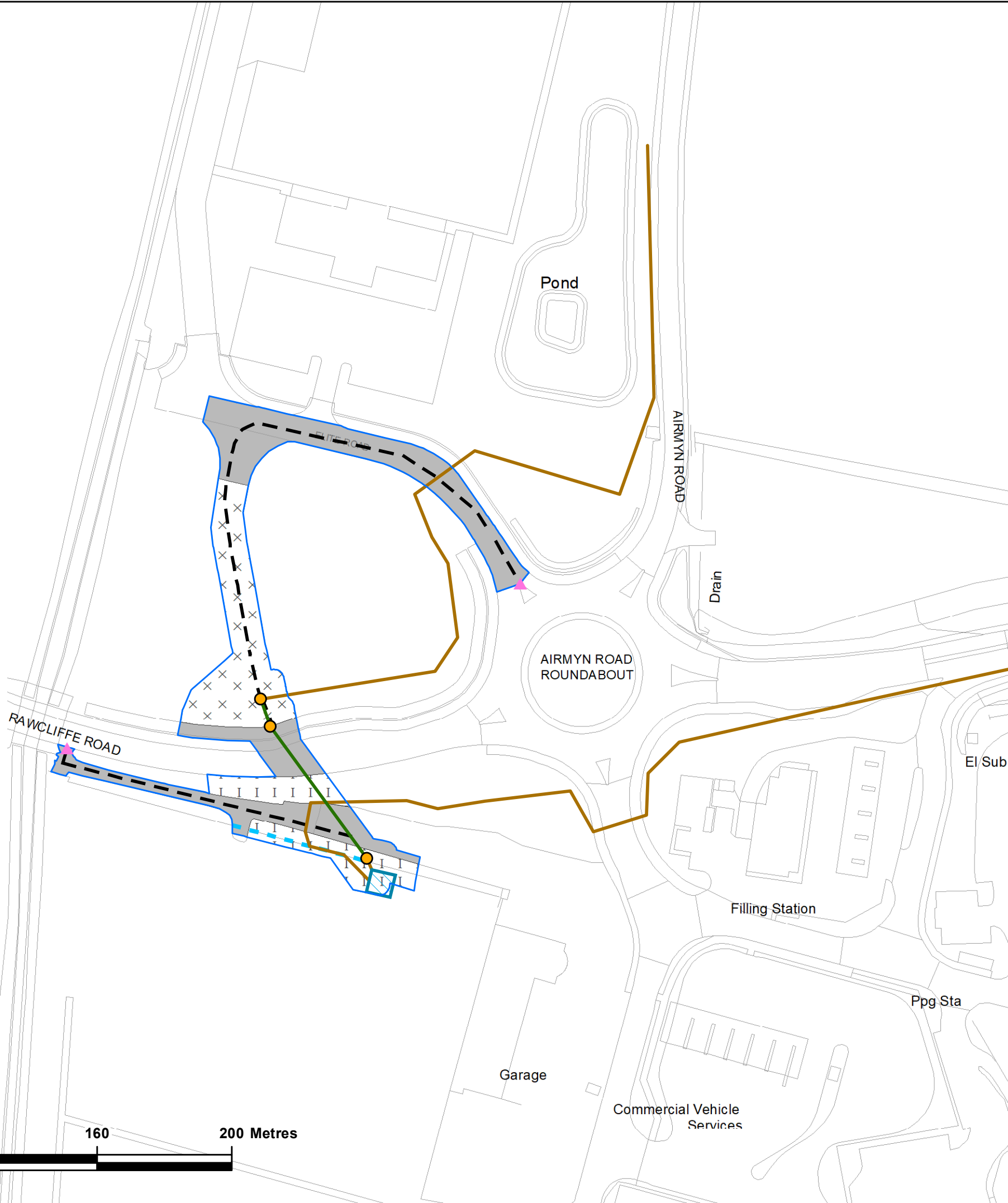

- Key:**
- Site Access
 - Existing 'Pole' (to be removed)
 - Proposed Order Limits
 - New 1000 kVA electrical substation already installed under ENQ23040725
 - Existing 11 kV OHL to be replaced with new section of underground electrical cabling installed by open cutting and filling
 - Existing 11 kV underground cabling (To be retained)
 - Proposed access
- Baseline Phase 1 Habitats**
- Dry ditch
 - Improved grassland
 - Hard standing
 - Cultivated/disturbed land - ephemeral/short perennial

Mapping reproduced by permission of Ordnance Survey on behalf of HMSO. Contains OS data © Crown Copyright and database right 2022



PROJECT TITLE			
DRAX BECCS DCO			
DRAWING TITLE			
8.5.2.4 - FIGURE 4 - OHL LANDSCAPE AND BIODIVERSITY PLAN - SHEET 2 OF 2			
DRAWING STATUS			
FOR ISSUE			
DRAWN	CHECKED	APPROVED	AUTHORISED
BS	PP	LR	DK
SCALE @ A3 SIZE		DATE	REVISION
1:1,250		19/04/2023	P03
DRAWING NUMBER			
EN010120-PC-8.5.2.4-Sheet 2			

